

OPERATION MANUAL

INFRARED ILLUMINATOR VT-IR1/110

IR Distance:	20M (65FT)
IR Angle:	65°



CHINA...ZL97 2 31205.6

TAIWAN ...142870

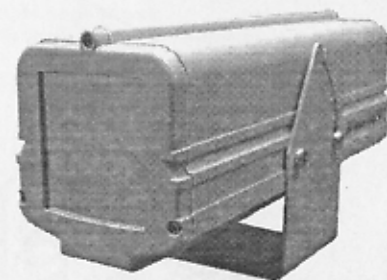

CE  IP33

VITEK

VITEK

INDUSTRIAL VIDEO PRODUCTS INC.

9907 Glenoaks Blvd. Unit B, Sun Valley, Ca. 91352

Tel.....818-771-0300

Fax.....818-771-0400

Http://www.vitekcctv.com

Copyright[®] by VITEK INDUSTRIAL VIDEO PRODUCTS INC.
All rights reserved. 11.01.99.

Operating components and connections

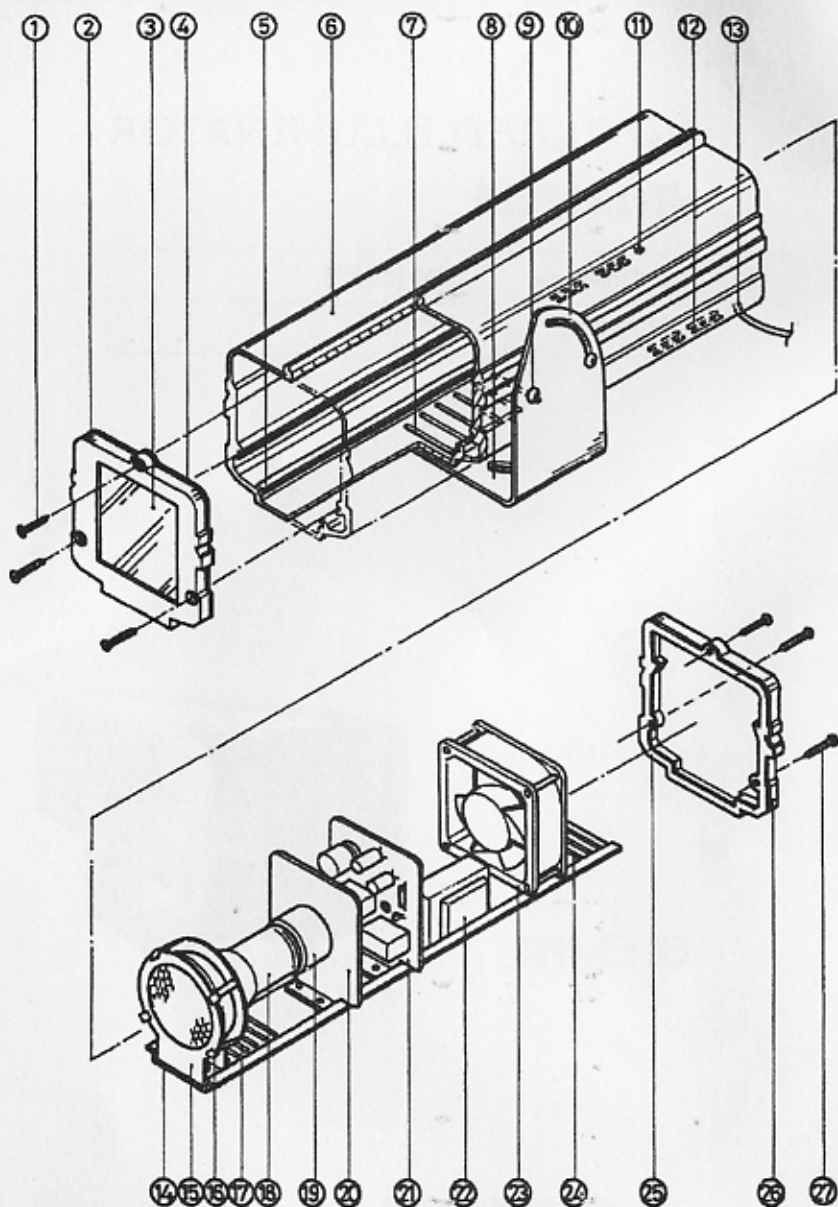

Thank you very much for purchasing this product. With these operating instructions you will be able to know the functions of this unit. Please read this manual first before using the product so that possible damage to the unit and possible injury to others due to improper use will be prevented.

1. Safety Approval

This appliance complies with the provisions of electromagnetic compatibility 89/336/EEC and the low voltage directive 73/23/EEC.

2. Safety Declaration

This unit uses potentially dangerous voltage. In order to prevent shock hazard, please do not open the cabinet. Refer all servicing to qualified service personnel. Any guarantee claim expires if the unit has been opened.

If this unit is used for purposes other than originally intended or if this unit is operated in the wrong way or not repaired by authorized skilled personnel, there is no liability for possible damage.

The infrared light emitted from the unit during operation is invisible to the human eyes and therefore, no visible light can be seen around the proximity. There will be partial red glare visible on the surface of the filter, which is normal.

The following are the operating components and connections diagrammed on the left.

3. Operating Components and Connections

- | | |
|--|--|
| (1) Attachment screws for the front cover | (13) Main cable (power source based on the input voltage shown on the unit) |
| (2) Front cover (material:PPS) | (14) Module plate |
| (3) Filter (coated, thickness:2mm)
NOTES:Please avoid the filter being touched by sharp or coarse objects as they might damage the coated filter and affect the working unit. | (15) Metal plate used for stabilizing lamp head |
| (4) Rubber seal | (16) Holes for attachment of metal plate |
| (5) Rail / power supply module | (17) Ventilation holes (for air outlet) |
| (6) Housing (material: Aluminum) | (18) Halogen Lamp |
| (7) Ventilation holes (for air outlet) | (19) Lamp holder (power supply to halogen lamp) |
| (8) Mounting bracket (connectable with other brackets for left and right angle adjustment) | (20) Heat-diffusion plate used to avoid heat generated by the lamp causing damage to the p c board |
| (9) Adjustment screws | (21) P C Board |
| (10) Arc type rail for up and down angle adjustment | (22) Transformer |
| (11) light sensor control (light under 2 Lux± 15%, power auto on) | (23) Fan (for heat dissipating) |
| (12) Ventilation holes (for air inlet) | (24) Ventilation holes (for air inlet) |
| | (25) Rubber seal |
| | (26) Back cover (material: PPS) |
| | (27) Attachment screws for the back cover |

4. Applications

The infrared illuminator offers an effective way of illuminating an area where low-lightness b/w ccd camera or day & night color camera are operating in the dark. (The general color camera are not suitable for use with IR illuminator)
It has an automatic light sensor control. When the light source is not sufficient (2 Lux± 15%), the infrared illuminator will turn on automatically.

- The lamp lifetime is approximately 2,000 hours, but because of varying conditions, they are not included in the guarantee period.
- This unit is suitable for both Indoor and Outdoor use (IP Rating: IP33)
- If this unit is to be fitted for outdoor use, please ensure that a suitable waterproof method of connection to the supply voltage is used. If in doubt, please consult a qualified person.

5. Suggestions

The wavelength of this unit is 840nm—1,200nm. Please make sure the b/w camera or day & night camera which you use to match this unit, is compatible to the above-mentioned wavelength and the illumination of your camera is under 0.5 Lux. If the camera is for outdoor use, it would be better to use auto iris lens with aperture F1.4 below as the effect would be much clear and obvious.

6. Different methods for installation

The following are several ways of matching and fixing the Infrared Illuminator. You can choose any of the installation methods according to your needs.

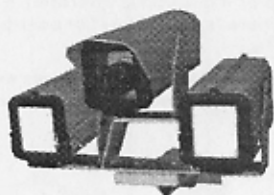

1. 1 PCS Camera + Housing
2 PCS Infrared Illuminator

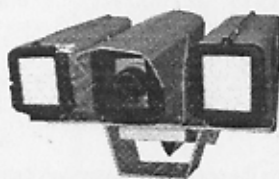

2. 1 PCS Camera + Housing
2 PCS Infrared Illuminator



3. 1 PCS Camera + Housing
2 PCS Infrared Illuminator



4. 1 PCS Camera + Housing
1 PCS Infrared Illuminator

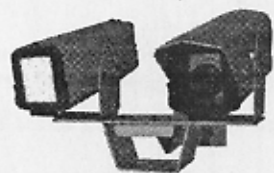

5. 1 PCS Camera + Housing
1 PCS Infrared Illuminator

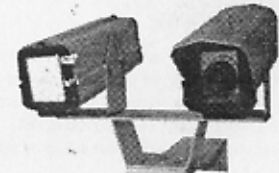

6. 1 PCS Camera + Housing
1 PCS Infrared Illuminator

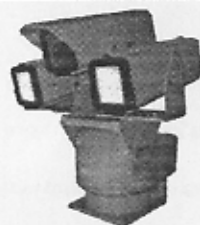

7. 1 PCS Camera + Housing
2 PCS Infrared Illuminator
1 PCS Pan/Tilt



8. 1 PCS Camera + Housing
1 PCS Infrared Illuminator
1 PCS Pan/Tilt

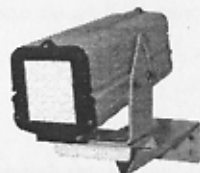

9. 1 PCS Infrared Illuminator

• The mounting bracket is not included, but can be separately purchased.

7. Installation process

- Step 1: Measure the projective angle of the camera and find a proper position for mounting the infrared illuminator.
- Step 2: Adjust the angle of the infrared illuminator to be horizontal with the camera angle.
- Step 3: Make sure the power input of your electric outlet is in accordance with the input voltage marking in the unit before plugging in the unit.
- Step 4: Arrange the power cord and signal cord in a safe and orderly manner.

- The suggested height for mounting this unit is approximately 3 to 4 m (10 to 12 FT) from the floor. If mounted too high, results may be less effective.
- Do not mount this unit upside down as this would enable water to enter the ventilation holes on base of the housing and may cause damage to the unit.
- If a Video Motion Detector is also used, the following precaution can be taken: Separation of 3m between the camera and infrared illuminator to avoid insect infiltration. This infiltration may cause a false alarm if above precaution is not taken.
- When in operation, this unit will generate a high temperature; therefore, do not place flammable objects near it.
- After the unit warms up, module may become very hot, so do not touch the unit.
- Maintain the unit between -5°C ~ 60°C (23°F ~ 140°F)
- If the unit falls or is damaged in any way, do not use the module. Please first contact a service representative before further use.
- If power cord is unretrievable, do not pull excessively on the cord causing damage to the unit.
- This unit must be grounded.

MEMO

8. Function testing

1. First check to make sure the unit has power.
2. If light source is sufficient, you can cover the light sensor control, item (11) to see if any red glare is on the surface of the filter or you can listen closely to make sure the unit has power.
3. If surrounding area is too dark, you may have to look closer to make sure unit is on.
4. If you are unable to detect the infrared illuminator to be working by using the above methods, please check monitor or VCR for picture.

• If the surrounding light is too bright, you may have to manually simulate night setting to see effectiveness.

9. Changing the light bulb

1. Firstly ensure that the power supply is disconnected.
2. When changing the light bulb, you must remove the 3 screws in the front cover firstly and then take out the front cover.
3. Use needle nose pliers to pull the module plate, item(14) out so that you can easily release the bulb.
4. Use the needle nose pliers again to stretch out the 4 long-strip metals and push aside the metal plate.
5. Use your left hand to hold the base of the lamp, while turning the bulb counter clockwise until released
6. Take out the light bulb from the socket.
7. Replace a new bulb and repeat the steps in sequence 5→4→3→2→1.

• Located on the front and back panels is the sealing tape. If removed, water damage could affect the unit
• It is recommended you return unit to factory for bulb replacement.

10. Cleaning

Unplug this unit before cleaning. Use clean and dry cloth for cleaning. Do not use a corrosive cleaner or chemical.

11. Specifications

Range	20m(65ft)
Angle	65°
Wavelength	840nm~1,200nm
Power Consumption	50 W
Lamp	Hologen lamp
Lamp specification	50PAR20/HAL/NFL30
Filter	Heat-resisting glass
Average Lifetime	Approx 2,000 hours
IR Rating	IP33
Heat Dissipation	Built-in fan/With ventilation holes
Power On	Light sensor control
Housing	Aluminum
Operation Temp	-5°C~+60°C (23°F~140°F)
Input Voltage	117VAC/230VAC
Dimensions	103(W)x130(H)x260(L)mm
Weight	Approx 1.55Kg (3.4 lb)

* Design and specifications are subject to change without prior notice.