



VT-TPTZ10HR-4N
VT-TPTZ18HR-4N

**4.0 MegaPixel H.265 IP PTZ
Cameras w/IR LED Illumination**

QUICK START GUIDE



FEATURES

- 1/3" 4.0 MegaPixel CMOS Sensor
- Up to 2592x1520 @ 30fps
- H.265/H.264/MJPEG Triple Streaming
- True Day/Night by IR Cut Filter
- Built-in 5mm to 50mm Lens offering 10x Optical Zoom (VT-TPTZ10HR-4N) / Built-in 4.8mm to 84mm Lens offering 18x Optical Zoom (VT-TPTZ18HR-4N)
- 6 Integrated IR LEDs with up to 165' IR Range (VT-TPTZ10HR-4N) / 10 Integrated IR LEDs with up to 500' IR Range (VT-TPTZ18HR-4N)
- DigitalNoise Reduction
- 220 Presets programmed with view direction, zoom, BLC, etc
- Max manual speed 480°/sec
- 360°continuous rotation
- 16:9 Video format
- Double layer metal body construction with IP66 Weather Resistance
- Includes Wall Mount Bracket & Power Supply
- ONVIF Compliant
- 12VDC Operation
- 3 Year Warranty



PLEASE NOTE:

Complete User Guide, Software, Tools, and Updates are available online. Scan the QR Code or visit:
<http://www.vitekccv.com/Downloads>



Package Contents

1. IP IR Speed dome
2. Wall mount bracket
3. Power supply
4. Screws kits
5. User manual

Dimensions

VT-TPTZ10HR-4N Dimensions:

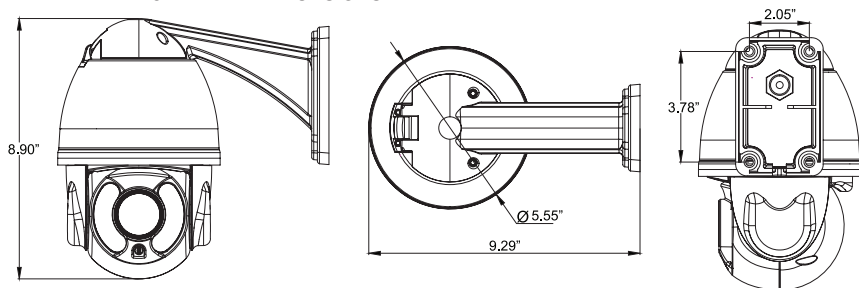

VT-TPTZ18HR-4N Dimensions:

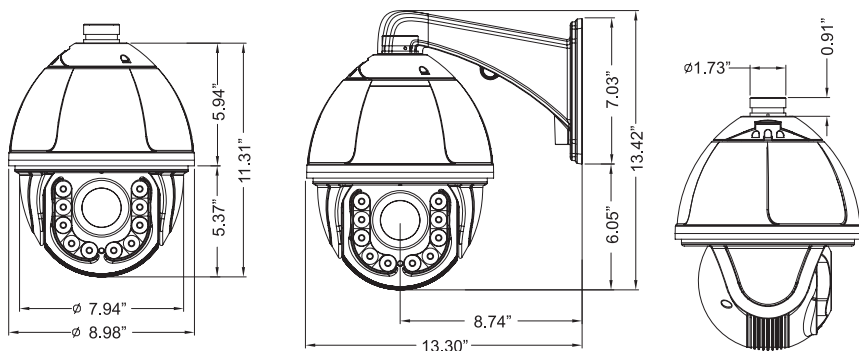

Wall Mount Installation

Wall mounted domes can be used in a hard wall structure whose thickness should be enough to install expansion bolts in an indoor and outdoor environment. The wall must bear at least 4 times the weight of the dome.

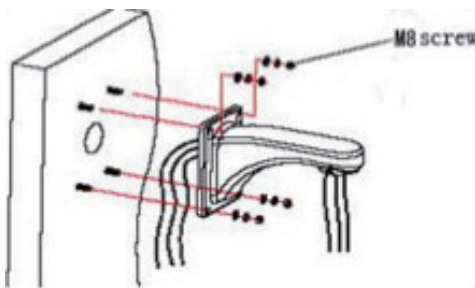
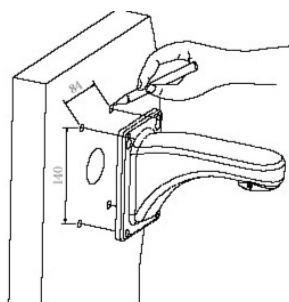
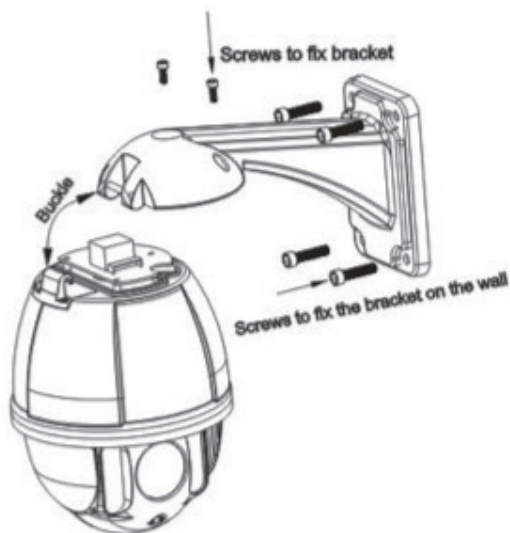

Attach the wall bracket to the wall, then feed the cables through it.

Setup & Configuration

1. With a computer running Windows 7 or above install IP Wizard
2. With computer connected to the same network that the IP PTZ is connected too, run IP wizard.

[illegible]

3. After IP Wizard is opened click on Search
4. IP Wizard will find all Transcendent IP PTZ cameras on the network

Setup & Configuration

The screenshot shows the IPWizard 2.2.5 application window. At the top, there are three tabs: "Device Browse", "Device upgrades", and "Device parameters defined". Below the tabs is a table with the following columns: number, Device type, Product info, IP address, Subnet mask, gateway, video port, http port, RTSP port, MAC Address, and Software version. The table is currently empty. Below the table, there are three sections for configuration: "Equipment information" (with fields for MAC Address, Verification Code, and Authorization code), "Equipment network information" (with fields for Device IP, Gateway, and Subnet mask), and "Equipment port information" (with fields for video port, http port, and RTSP port). Each section has a "Modify" button. There is also a "Restart" button and a "search" button.

number	Device type	Product info	IP address	Subnet mask	gateway	video port	http port	RTSP port	MAC Address	Software version
--------	-------------	--------------	------------	-------------	---------	------------	-----------	-----------	-------------	------------------

Equipment information

MAC Address: 00-30-40-11-00-07

Verification Code: Get

Authorization code: Clear Passwords

Restart

Equipment network information

Device IP: 192.168.1.100

Gateway: 192.168.1.1

Subnet mask: 255.255.255.0

Modify network

Equipment port information

video port: 8080

http port: 8081

RTSP port: 8082

Modify the port

search

6. Once camera is highlighted you can change the IP address or ports by making changes and then clicking on "Modify"
7. Once changes are completed double click on the IP camera you want to connect too. IE will open and direct you to the login screen of the camera.
8. Default User name and Password are admin/admin

Setup & Configuration



9. After logging into camera click on “Browse” for live view or “Settings” for detailed programming



Setup & Configuration

[illegible]

5. Once camera(s) are found highlight the camera that needs to be changed

Setup & Configuration

Browse

Setting

System

Network

Camera

Video&Audio

PTZ Function

Alarm

Record

Manage Users

Log

SystemTimeAdvanced

Basic information

Version: V1.04.10-160612Time zone: GMT-07:00Product info: IPD-D41C02-B5 seriesSerialNum: 1B4B511C030A

Network settings

HAC address: 10-7C-49-11-00-07IP address: 192.168.1.210Default gateway: 192.168.1.1Subnet mask: 255.255.255.0

Alarm settings

Alarm server 1 IP: 0.0.0.0Alarm server 2 IP: 0.0.0.0Alarm server 3 IP: 0.0.0.0

NTP settings

NTP server 1: 192.168.1.100

video settings

Public video parameters:

Brightness: 128Contrast: 128Saturation: 128Sharpness: 128

Main stream parameters:

Resolution: 2592x1520Frame rate: 15Bit rate: 3072KbpsI/P rate: 50

Sub stream parameters:

Resolution: 640x480Frame rate: 30Bit rate: VBR(upper limit: 768Kbps)I/P rate: 50

MJPEG video settings