



VTC-IR403-212NP
VTC-IR403-550NP
Virtuoso Series 3.15MP WDR
IP Cameras with 40 IR LEDs

QUICK START GUIDE



FEATURES:

- 1/2.8" Sony® 3.23 MegaPixel RGB Bayer Array CMOS
- Up to 30fps live view @ 2048 x 1536 (3.15 MegaPixel)
- MegaPixel IR Corrected 2.8-12mm Motorized Varifocal Lens with 1 click focus for easy Configuration or MegaPixel IR Corrected 5-50mm Varifocal Auto Iris Lens with External Adjustments for Focus and Zoom
- 40 Dynamic Infrared LEDs at 850nm enable viewing in total darkness up to 150 feet
- Dual Glass Compartments to Eliminate IR Reflection
- XD-DNR (2D-DNR + 3D-DNR) Noise Reduction
- True Day/Night by ICR - Dual Filter Switch
- Triple Streaming (H.264/MJPEG) offering Extensive Integration Possibilities
- Real-time Lens Distortion Correction (LDC) for an optically correct picture
- Compliance with the latest Onvif Profile S
- On-board network security with IP address filtering
- Advanced OSD Features including Image Stabilization & Corridor Mode
- MicroSD memory card slot for Local recording supporting up to 128GB MicroSDXC cards
- 3-Axis mount with Simple One Turn Positioning Lock for Ease of Installation
- IP-68 Rated Water Resistance
- 12VDC, 24VAC and PoE (Power over Ethernet) Operation



PLEASE NOTE:

Complete user guide available online. Scan the QR Code or visit:
http://www.vitekctv.com/Manuals/Virtuoso-IP_Operation-Manual.pdf

VITEK

Safety Precaution

- To prevent fire or shock hazard, do not expose the unit to rain or moisture.
- To prevent electric shocks and risk of fire hazards, do NOT use other than specific power source.

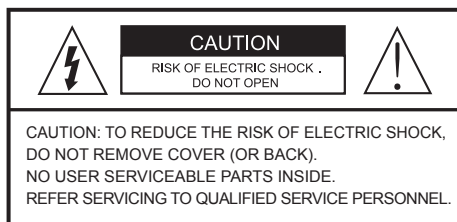

The symbol is intended to alert the user to the presence of uninsulated "dangerous voltage" within the product's enclosure that may be of sufficient magnitude to constitute a risk of electric shock to persons.



The symbol is intended to alert the user to the presence of important operating and maintenance(servicing) instructions in the literature accompanying the unit.

• **Warning :**

This equipment has been tested and found to comply with the limits for a Class A digital device, pursuant to part 15 of the FCC Rules. These limits are designed to provide reasonable protection against harmful interference when the equipment is operated in a commercial environment. This equipment generates, uses, and can radiate radio frequency energy and, if not installed and used in accordance with the instruction manual, may cause harmful interference to radio communications. Operation of this equipment in a residential area is likely to cause harmful interference in which case the user will be required to correct the interference at his own expense.

• **Caution :**

Any changes or modifications in construction of this device which are not expressly approved by the party responsible for compliance could void the user's authority to operate the equipment.

Mains power quality should be that of a typical commercial environment. If the user of the model requires continued operation during power mains interruptions, it is recommended that the model be powered from an uninterruptible power supply (UPS) or a battery.

Composition

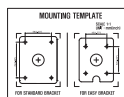
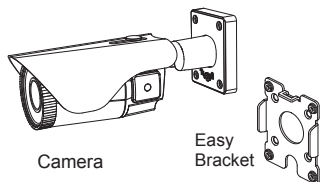

Mounting Template



Cable Signal Sticker

Plastic Anchor:
6 x 30mm (3pcs)



Mounting Screw:
4 x 40mm (3pcs)



Assembly Screw:
4 x 15mm (4pcs)



Torque Wrench:
3mm (1pc)



Quick Start Guide



Coupler for RJ45 Cable (1pc)



Installation CD



Wiring Connector (1pc)

Dimensions

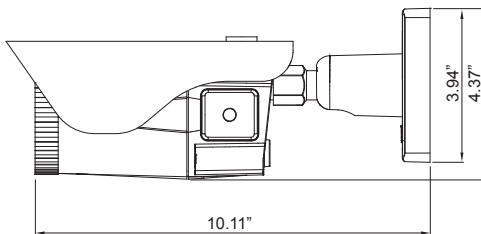
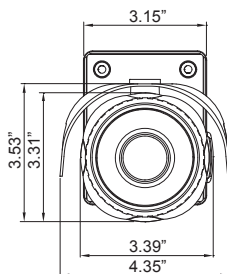

Part Names

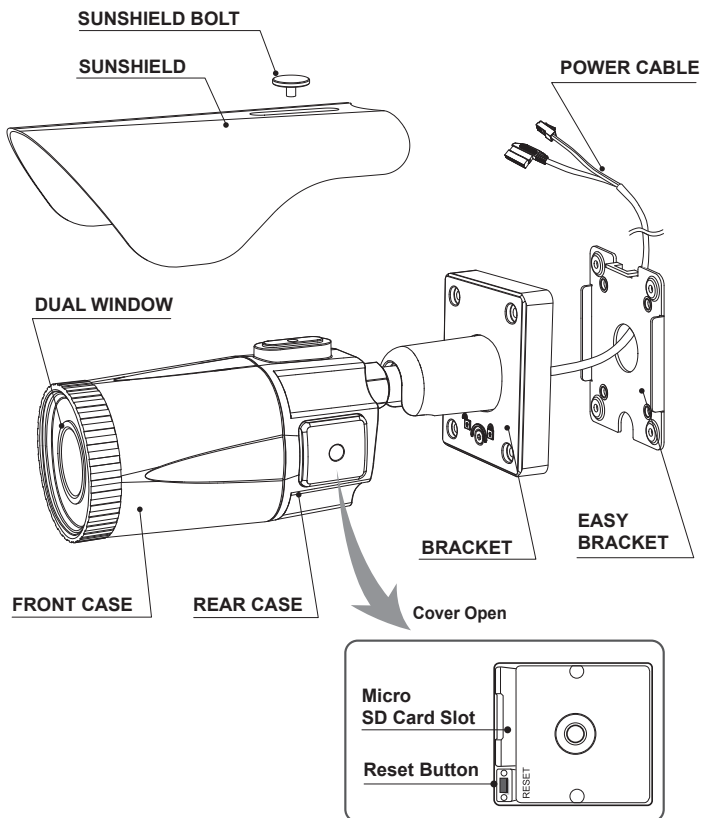

CAUTION

- Extreme care should be taken NOT to scratch the window in front of lens.
- Care should be taken that the cable is NOT damaged, kinked, or exposed in a hazardous area.
- Do not point the camera lens directly at the sun or a spot light.

Installation Instructions

1. Place the mounting template at the installation position and drill the ceiling or wall if needed. (*The easy bracket can not be installed on the ceiling)
2. Place the easy bracket on pre-drilled position and attach using mounting screws(4x30mm). Skip this step when an easy bracket is not installed.
3. Route the power cable to the connecting place.
Hook up the camera bracket with the easy bracket as illustrated below.
4. Attach the camera bracket using assembly screws (4x14mm).
5. Set the camera's viewing angle.
6. Install the sunshield on to the camera unit and tighten the sunshield-bolt.

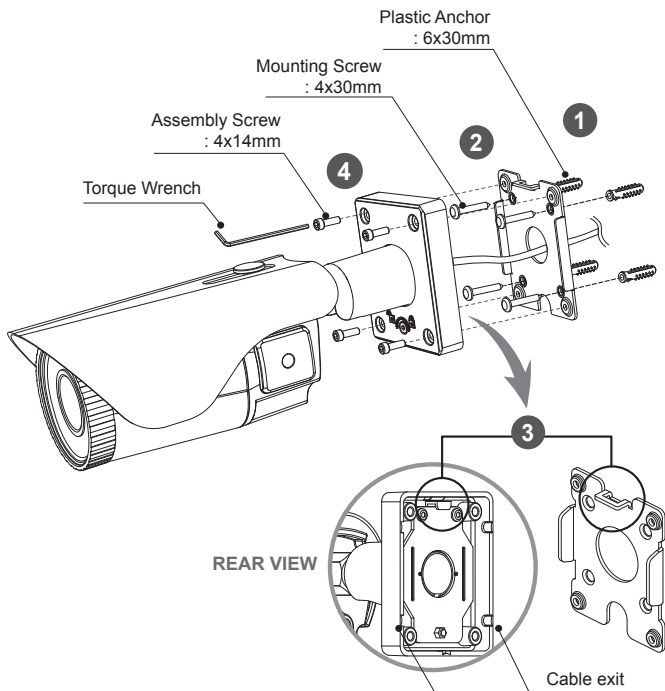

Installation Instructions

Pan & Tilt adjustments

- Unlock the screw on the camera bracket using the torque wrench supplied
- Set the camera's viewing angle then lock the screw on the bracket.

1) Pan limit:

Pan is limited to +/- 90°.

2) Tilt limit:

Tilt is limited to 0°(2°) min ~ 90° max.
for wall(ceiling) installation respectively
with reference to the wall(ceiling) when
the inclination of camera module is 0°,
that is, the image is aligned horizontally.

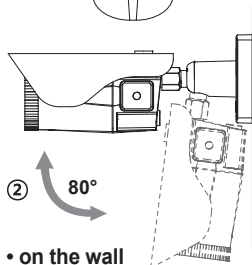
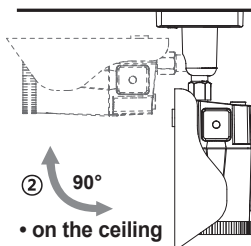
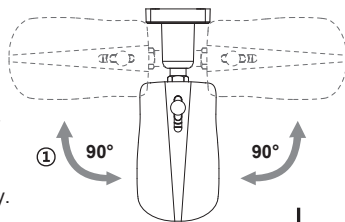

3) Inclination limit

(Horizontal image alignment):

Inclination limited to +/-90° max.

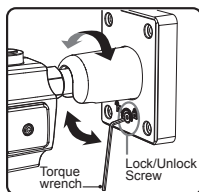
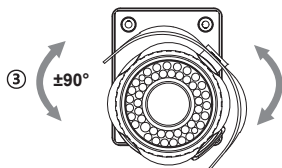

■ Adjustment of viewing angle
with one-touch 3-Axis bracket

Zoom & Focus adjustments (VTC-IR403-550NP Only)

Use the torque wrench supplied.

- Turn the Focus gear to "N"(Near) or "∞"(Far)
until the sharpest focus is made.
- To widen the viewing angle, turn the Zoom to
"W"(Wide) and to obtain a closer view, turn it
to "T"(Tele)

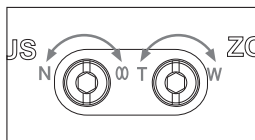

Virtuoso Quick Start Guide

1. PC Requirements

1. Operating System

- Windows Vista (32 bit) Ultimate, Business Edition
- Windows 7, 8, 10 (32/64 bit) Ultimate, Professional Edition

2. Processor

- Intel Core 2 Duo 2.4 GHz or higher (for using 1920*1080 30 fps)
- Intel Core i7 2.8 GHz or higher (for using 2048*1536 30fps)

3. Memory

- 2 GB or more

4. Resolution

- 1280X1024 pixels or higher (32 bit color)

5. Web Browser

- Microsoft Internet Explorer Ver. 9.0, 10.0 or Higher
- Safari Ver. 4.0 (Plug-in free viewer only)
- Google Chrome Ver. 4.0 (Plug-in free viewer only)

2. IP Manager

The IP Manager can be installed by locating the program on the enclosed CD or visiting: www.vitekcctv.com/support/downloads

1. Open IP MANAGER

2. Highlight the camera and right click

3. Click the "Change IP" button.

4. Input IP Address and Subnet, Gateway and click the button "OK".

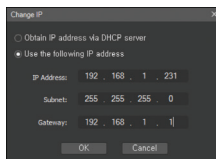
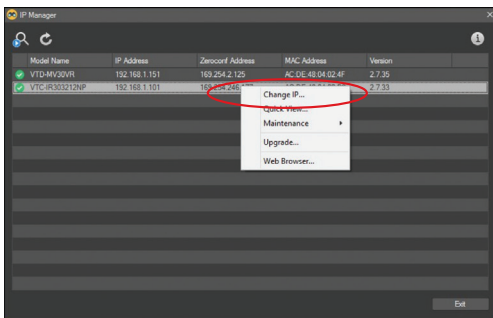

Virtuoso Quick Start Guide

3. Accessing the IP Camera

1. Open Web browser
2. Type IP address
 - Enter the camera's IP address in Internet Explorer® address bar.
 - The default IP address is 192.168.0.10
 - The default User ID and Password is admin / admin

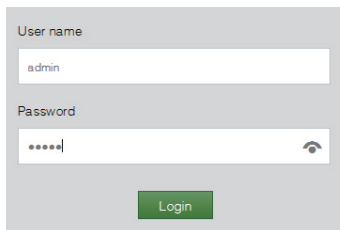

User name

Password





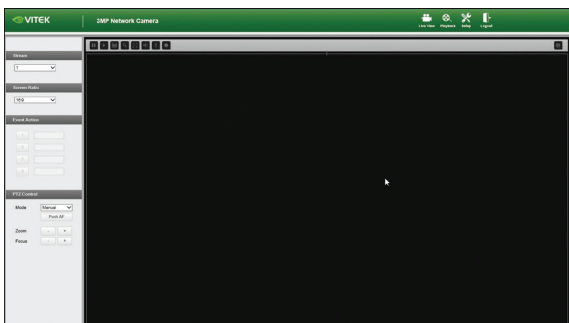

Login

4. Live View Page

The network camera's Live View page appears in your browser after successful login.



ICONS:

-  **Live:** Displays live video.
-  **Setup:** Enters setup menu.
-  **Exit:** Exit current login and/or Enter new login.
-  **Snapshot:** Take a picture of the video image currently on display. Supports original image size, view, print, and save feature.
-  **Zoom:** Supports a digital zoom in live video image.
-  **Full screen:** Expand the current windows into maximum monitor size.
-  **Information:** Shows the current major setting status.

LEFT COLUMN SETTINGS:

- Stream:** Specify the viewable video stream source to display in live view page.
- Screen Ratio:** Specify the viewable video size to display in live view page.
- Event Action:** Used to start or stop an event manually according to event

Virtuoso Quick Start Guide

5. Quick Setup Menu

Enter the setup menu icon on the Web Viewer.



Setting the Quick setup menu.

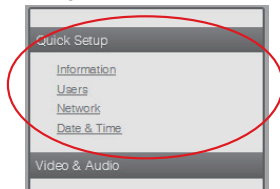

5-1. Information

The Information shows the camera basic information such as Model name, MAC address, IP address, Zeroconf IP address and Firmware version.

Information	
Model	XXX-XXXX
MAC Address	AC:DE:48:04:02:8E
IP Address	192.168.0.118
Zeroconf IP Address	169.254.184.165
Firmware Version	2.7.XX

5-2. Users

User accounts can be added or modified or removed. The authority depends upon user group automatically and shows the permission status to access the menus.

- Name: Shows the name registered name to access the camera.
- Group: Shows the assigned permission given to users.
- Authority: Shows the permission status to access the menus.

Users		
User List		
Name	Group	Authority
admin	administrator	live, setup, system

Click the Add, Edit, or Delete button for managing user account.

5-2-1. Add

To add a new user:

1. Click the Add tab, and type a new user name. (1 to 14 alphanumeric characters).
 - User names are not case sensitive.
2. Type a password and retype confirm password. (1 to 8 alphanumeric characters).
 - Passwords are case sensitive.
3. Select one of the groups you wish to assign to the user.
4. Click the OK button to save the settings and add a new user

Virtuoso Quick Start Guide

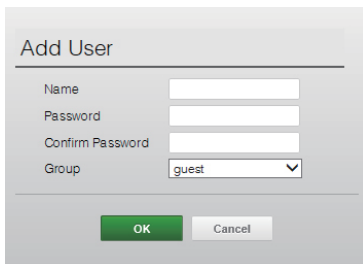

Add User

Name

Password

Confirm Password

Group

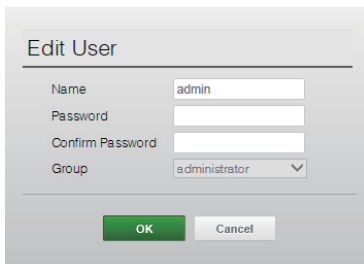

Edit User

Name

Password

Confirm Password

Group

5-2-2. Edit

To edit a user:

1. Select one of the User Names in the User List you want to modify.
2. Click the Edit tab, then new pop-up window appears.
3. Type a password (1 to 8 alphanumeric characters) and retype confirm password.
 - **The user name can't be modified.**
4. Select one of the groups you wish to assign to the user.
5. Click the OK button to save the settings and modify a user.

5-2-3. Delete

To delete a user:

1. Select one of the User Names in the User List you want to remove.
2. Click the Delete tab. A dialog box appears with confirmation message.
3. Click the OK button. The user profile is removed from the User List profile.

5-3. Network

IP Address:

The DHCP (Dynamic Host Configuration Protocol) server has a feature that automatically assigns an IP address to the device if there is a device on the network.

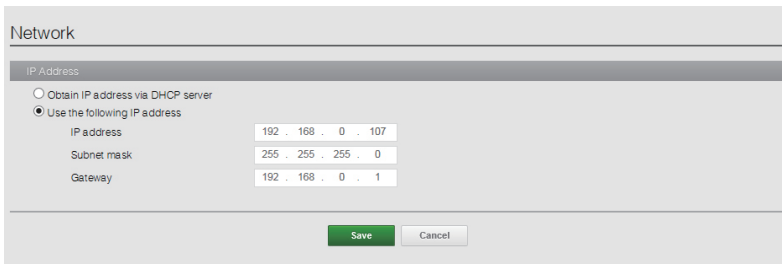

Network

IP Address

Obtain IP address via DHCP server

Use the following IP address

IP address	<input type="text" value="192 . 168 . 0 . 107"/>
Subnet mask	<input type="text" value="255 . 255 . 255 . 0"/>
Gateway	<input type="text" value="192 . 168 . 0 . 1"/>

Virtuoso Quick Start Guide

- Obtain IP address via DHCP :
Select the choice box if you want to assign the IP address from DHCP server automatically, and then the remaining setting are read-only text.
- Use the following IP address:
Select the choice box if you want to assign the IP address manually.
- IP address:
The address of the camera connected to the network. Specify a unique IP address for this network camera.
- Subnet mask:
The address that determines the IP network that the camera is connected to (relative to its address). Specify the mask for the subnet the network camera is located on.
- Gateway:
The Gateway that accesses other networks. Specify the IP address of the default router (Gateway) used for connecting devices attached to different networks and network segments.

5-4. Date & Time

Date & Time

Current Time

Date Time

New Time

Synchronize with computer time
Date Time

Set manually
Date Time

Synchronize with NTP server
NTP Server Interval [Hour]

Time Zone

Automatically adjustment for daylight saving time changes

Date & Time Display

Date Format

Time Format

Virtuoso Quick Start Guide

5-4-1. Current Time

Shows the current date and time.

- Date: The default setting is 1970-01-01.
- Time: The default setting is 00:00:00.

5-4-2. New Time

Select one of the server time.

- Synchronize with computer time:
Sets the time according to the clock on your computer.
- Set manually: Using this option allows you to manually enter the date and time.
- Synchronize with NTP Server:
This option will obtain the correct time from an NTP server every 60 minutes.
The NTP server's IP address or host name is specified in the time server.

5-4-3. Time Zone

Select the time zone where your camera is located. Click the "Automatically adjust for daylight saving changes" checkbox to automatically update the time changes caused by daylight saving.

- Time zone: The default setting is GMT.

5-4-4. Day & Time Display

Select one of the Date and Time format.

- Date Format: The default setting is YYYY-MM-DD.
- Time Format: The default setting is 24 hours.

*** For more details, refer to enclosed CD.**

Virtuoso Quick Start Guide

If you suspect a problem is being caused by incorrect configuration or some other minor problem, consult the troubleshooting guide below.

Upgrading the Firmware

Firmware is software that determines the functionality of the network camera. One of your first actions when troubleshooting a problem should be to check the current firmware. The latest version may contain a correction that fixes your particular problem. The current firmware version in your camera is displayed on the Basic Configuration or About. For the latest firmware of the camera, please contact your product administrator.

Detailed instructions on how to perform the upgrade process are provided with each new release. See also the Maintenance / Upgrade for more information.

General Troubleshooting

The following list covers some of the problems that may be encountered and suggests how to remedy them:

Symptom	Guide
The camera cannot be accessed by some clients.	If using a proxy server, try disabling the proxy setting in your browser. Check all cabling and connectors.
The camera works locally, but not externally	Check if there are firewall settings that need to be adjusted. Check if there are router settings that need to be configured.
Poor or intermittent network connection.	If using a network switch, check that the port on that device uses the same setting for the network connection type (speed/duplex).
The camera cannot be accessed via a host name.	Check that the host name and DNS server settings are correct.
Not possible to log in.	When HTTPS is enabled, ensure that the correct protocol (HTTP or HTTPS) is used. When attempting to log in, you may need to manually type in http or https in the browser's address bar.
No image using Refresh and/or slow updating of images.	If images are very complex, try limiting the number of clients accessing the camera.
Images only shown in black & white.	Check the Video & Image setting.
Blurred images.	Refocus the camera.

Virtuoso Quick Start Guide

Poor image quality.	Increased lighting can often improve image quality. Check that there is sufficient lighting at the monitored location. Check all image and lighting settings.
Rolling dark bands or flickering in image.	Try adjusting the Exposure Control setting under AE and AWB part.
H.264 not displayed in the client.	Check that the correct network interface is selected in the Video & Image/Stream.
Multicast H.264 not displayed in the client.	Check with your network administrator that the multicast addresses used by the camera are valid for your network. Check that the Enable multicast checkbox are enabled in the System/Network/RTP tab. Check with your network administrator to see if there is a firewall preventing viewing.
Multicast H.264 only accessible by local clients.	Check if your router supports multicasting, or if the router settings between the client and the server needs to be configured. The TTL value may need to be increased.
Color saturation is different in H.264 and Motion JPEG.	Modify the settings for your graphics adapter. Please see the adapter's documentation for more information.
Poor audio quality.	Too many users/clients connected to the camera may affect the sound quality adversely. Try limiting the number of clients allowed to connect.
Distorted audio.	Check that the correct Audio Input source is selected. Select Microphone for a connected external microphone. Select Line for a connected line in source.

[NOTE]

If you cannot find the help you require, please see the User's Manual, or contact your network administrator.

Virtuoso Quick Start Guide

Setup Menu table

Main MENU	Sub MENU	CONFIGURATION	
Quick Setup	Information		
	Users	Add / Edit / Delete	
	Network	IP Address	
	Date & Time	Current Time / New Time / Time Zone / Date & Time Display	
Video & Audio	Video	Video Source / Video Stream1 / Video Stream2 / Video Stream3	
	Audio(*)	Audio Stream / Audio Input / Audio Output	
	Image	Basic	Appearance Control
			Brightness / Contrast / Saturation / Hue / Sharpness
		OSD	OSD Control
			Enable text OSD / Enable date&time OSD / Enable zoom&focus
		AE	Exposure Control
			Mode / Shutter / Min.Shutter / Max.Shutter / Gain / Min.Gain / Max.Gain / Auto Iris / Auto Flickerless
		AWB	White Balance Control
			Mode / Cb Gain / Cr Gain
		AF	Focus Control
			Mode / Speed / Lens Calibration / Enable Day & Night sync focus / Enable lens locking
		Day/Night	Day & Night Control
			Mode / Switch Time / Threshold
		WDR	Digital WDR Control
	Mode / Level		
	Defog Control		
	Mode		
	BLC	BLC Control	
Mode / Level			
HLC Control			
	Mode		
DNR	2DNR(Mode / Level), 3DNR(Mode, Level)		
Corridor	Rotation		
LDC	Mode / Level		
Privacy Mask	Color		
Digital Zoom	x1.0 ~ x16.0		

Virtuoso Quick Start Guide

Events	Motion Detection	Sensitivity
	Triger	Alarm In(*) / System / Manual / Network
	Action	Alarm Out(*) / E-Mail / FTP / Video
	Rule	
Record	Record	Record / Schedule / Storage
Video Analytics	Tamper	
System	Security	Users / HTTPS / IP Filer / ONVIF
	Date & Time	Current Time / New Time / Time Zone / Date & Time Display
	Network	TCP/IP / DDNS / RTP / UPnP / Zeroconf
	Language	English / Korean / Russian
	Maintenance	Maintain / Update / Setup Export / Setup Import
	Logs & Report	Logs / Report

(*) Not Available

Detailed Specifications	VTC-IR403-212NP	VTC-IR403-550NP
Sensor	Sony 1/2.8" Progressive Scan CMOS Sensor	
Resolution	3.15 MegaPixel (2048x1536)	
Video Encoding	H.264 / MJPEG triple streaming	
Frame Rate	30fps max	
IR Illuminators	40 850nm Dynamic Intensity IR LEDs	
IR Range	150'	
Lens	2.8-12mm Motorized Varifocal Lens with 1 click focus for easy Configuration	MegaPixel IR Corrected 5-50mm Varifocal Auto Iris Lens
Corridor Format	90° / 270°	
Digital Zoom	0 ~ x16	
Minimum Illumination	Color Mode: 0.15 lx at 50IRE/30fps / B/W Mode: 0.00 lx 30fps With IR on	
Day/Night	Auto True Day/Night (TDN)	
Electronic shutter speed	Min. 1/10,000 sec ~ Max. 1/30 sec	
White Balance	ATW-Indoor/Outdoor, Shade, Clear sky, Fluorescent light, Light bulb, Flame, Manual	
DSS (Sens-Up)	AUTO	
Noise Reduction	XD-DNR (2D-DNR+3D-DNR)	
WDR	Digital WDR (ATR-EX)	
Privacy	Max.8 Area Selection	
Motion Detection	YES	
Advanced OSD Functions	Privacy Mask, Motion Detection, Tamper, Defog, D-Zoom, HLC/ BLC, LDC (Lens Distortion Correction), Mirror/Flip, Hue, Brightness, Contrast, Saturation, Sharpness	
Memory Card	MicroSD - up to 128GB	
Video Streaming	Simultaneously H.264 and MJPEG (Triple Streaming) Independent Frame Rate and Bandwidth Control, VBR/CBR Mode	
Connectivity	Up to 10 simultaneous user connections	
Weather Resistance Rating	IP-68	
Input Voltage	12VDC / 24VAC / PoE	
Power Consumption (12VDC)	380mA (IR Off) / 700mA (IR On)	
Power Consumption (24VAC)	300mA (IR Off) / 500mA (IR On)	
Power Consumption (PoE)	7.3 Watts	
Operating Conditions	14°-122°F (-10°-50°C) < 80% RH	
Dimensions (W x H x D)	4.35" x 4.33" x 10.11" (110.5 x 110 x 260mm)	
Weight	2.98 lbs (1350g)	



**CONSIDER THESE OTHER
GREAT PRODUCTS FROM**



OnCue IP NVR Series:

VT-NV Series Stand-alone Real-time IP Network Video Recorders with Real Time HD Recording on all channels and shares the same local and remote software platform as our award winning OnCue HD-SDI / EX-SDI recorders. The Advanced OnCue Central Monitoring software (CMS) is capable of connecting multiple OnCue NVRs and HD-SDI / EX-SDI recorders. Up to 6 Internal SATA2 HDD Slots support up to 24TB (6 x 4TB HDD) using Advanced HDD Format plus optional eSATA for storage expansion (up to 5 more HDD).



OnCue IP "S" NVR *4, 8, and 16 Channel Real Time IP Network Video Recorders*

- Full HD (720p/1080p) Real-time recording with 120fps live display & playback
- Internal 4-Port PoE Switch
- Supports up to 12GB Internal Storage (3x4TB - 8 & 16 Channel Models) / 8GB (2x4TB - 4 Channel Model)
- eSATA for storage extension of up to 5 more HDD (8 & 16 Channel Models)
- Plug & Play and Auto configuration for VITEK ENVI IP Cameras and many leading ONVIF compliant Cameras
- Convenient Panorama (Thumbnail) Search



OnCue IP "P" NVR *8, 16, and 32 Channel Real Time IP Network Video Recorders*

- Full HD (720p/1080p) Real-time recording, live display, and playback
- Internal 8-Port PoE Switch
- Supports up to 24GB Internal Storage (6x4TB)
- eSATA for storage extension of up to 5 more HDD
- Standard Rack Mount Width (Rack Ears Included)
- Plug & Play and Auto configuration for VITEK ENVI IP Cameras and many leading ONVIF compliant Cameras
- Convenient Panorama (Thumbnail) Search

LIMITED PRODUCT WARRANTY

VITEK products carry a three (3) year limited warranty. VITEK warrants to the purchaser that products manufactured by VITEK are free of any rightful claim of infringement or the like, and when used in the manner intended, will be free of defects in materials and workmanship for a period of three (3) years, or as otherwise stated above, from the date of purchase by the end user. This warranty is nontransferable and extends only to the original buyer or end user customer of a VITEK Authorized Reseller.

The product must have been used only for its intended purpose, and not been subjected to damage by misuse, willful or accidental damage, caused by excessive voltage or lightning.

The product must not have been tampered with in any way or the guarantee will be considered null and void.

This guarantee does not affect your statutory rights.

Contact your local VITEK Reseller should servicing become necessary.

VITEK makes no warranty or guarantee whatsoever with respect to products sold or purchased through unauthorized sales channels. Warranty support is available only if product is purchased through a VITEK Authorized Reseller.



28492 CONSTELLATION ROAD VALENCIA, CA 91355
WWW.VITEKCCTV.COM

Version 2.0
May 2016