

Vandal Mighty Dome

Vandal Proof Dome
Camera Series



Fully Gasketed IP68 Rated Weatherproof Design. (Outdoor Vandal Version Only)



May be Surface (Includes Surface Mount Casing) or Semi-Flush Mounted for Sleek, Low Profile Installation.

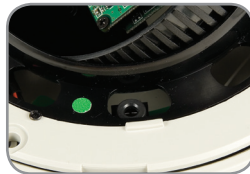

Secondary Video Output Enables Ease of Adjustment after Installation.



Friction Fit Ball Mount Camera Module Can Achieve Virtually Any Viewing Angle.



The NEW Mighty Dome Vandal base has been designed to manage and protect video and power cables without the need for external adaptors.

FEATURES

- High Resolution 480 or Super High Resolution 550 TV Line Cameras
- True Mechanical Day/Night function available
- Flush or Surface Mount
- UTP Interface & Heater / Blower Options Available
- Dual Voltage 12VDC & 24VAC
- Infinity Ball Mount for Any Viewing Angle
- Fully Gasketed IP68 Rated Weatherproof Design
- Lens options: 2.9-10mm, 9-22mm, and 18-50mm
- 1" Conduit Knockout
- Available in Ivory or Black

Available Configurations Include:

VTD-MVH2910 / VTD-MVH922

Vandal Proof Color Dome Camera w/2.9-10mm or 9-22mm Varifocal Lens & 480TVL

VTD-MVX2910 / VTD-MVX922 / VTD-MVX1850

Vandal Proof Color Dome Camera w/2.9-10mm, 9-22mm, or 18-50mm Varifocal Lens & 550TVL

VTD-MVH2910DN / VTD-MVH922DN

True Mechanical Day/Night Vandal Proof Color Dome Camera w/2.9-10mm or 9-22mm Varifocal Lens & 480TVL

VTD-MVX2910DN / VTD-MVX922DN / VTD-MVX1850DN

True Mechanical Day/Night Vandal Proof Color Dome Camera w/2.9-10mm, 9-22mm, or 18-50mm Varifocal Lens & 550TVL



Mighty Dome Inside (Shown in Black)



UTP Interface and Heater & Blower Options Available



(888) VITEK-70 | WWW.VITEKCCTV.COM
28492 Constellation Road Valencia, CA 91355

Vandal Mighty Dome

Vandal Proof Dome
Camera Series

Detailed Specifications	VTD-MVH2910 / MVH922	VTD-MVX2910 / MVX922	VTD-MVH2910DN / MVH922DN	VTD-MVX2910DN / MVX922DN
Image Sensor	1/3" Sony New Structure Super HAD CCD		1/3" Sony True Day/Night Super HAD CCD	
Sync System	Internal			
Scanning system	2:1 Interlace			
Lens Options	2.9-10mm, 9-22mm, or 18-50mm			
Horizontal Resolution	480 TV Lines	550 TV Lines	480 TV Lines	550 TV Lines
Min. Illumination	Day/Night: 0.02Lux (F1.2@40IRE) / Standard: 0.2Lux (F1.2@40IRE)			
S/N Ratio	More than 50dB AGC OFF at 50IRE			
Video Output	1.0Vp-p composite, 75 Ohms			
Effective Pixels	768(H) x 494(V)			
Electronic Shutter	1/60 ~ 1/100,000			
White Balance	2000~8000 K Automatic Tracking			
Weatherproof	IP68			
Operating Temperature	14°F ~ 122°F (-10°C ~ +50°C)			
Operating Humidity	Within 85% RH			
Power Consumption	3 Watts			
Power Requirement	12VDC/24VAC Dual Voltage (500 mA Minimum)			
Dimensions (H x Dia.)	4.45" x 6.73" (113mm x 171mm)			
Weight	1.05 lbs. (16.8 oz.)			



VT-MDPLMT
Mighty Dome Pole
Mount



VT-MDCNMT
Mighty Dome Corner
Mount



VT-MD/CMT
Mighty Dome Ceiling
Mount



VT-MD/WMT
Mighty Dome Wall
Mount



VT-MD-2VOC
Cable for Secondary
Video Output

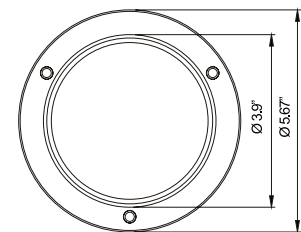
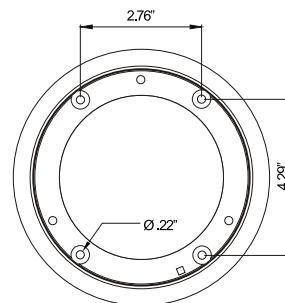
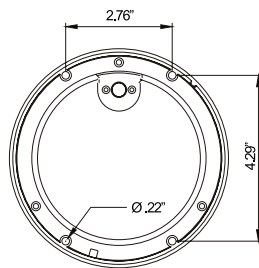
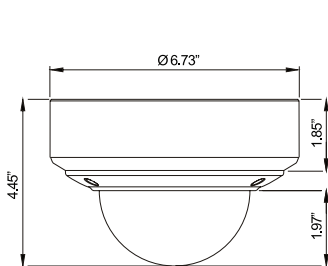

(888) VITEK-70 | WWW.VITEKCCTV.COM
28492 Constellation Road Valencia, CA 91355